

SpiralTrac™ Packing Version Quote Form

Configuration

Note: For vertical turbines please refer to the *Vertical Turbine Quote Form* at enviroseal.ca

1. Sufficient flush pressure (1 Bar/15 psi above box pressure) to ensure a positive flow into the box is required.
2. EnviroSeal recommends that a flow meter and a check valve be utilized on the flush line.
3. Vertical applications sized the same as horizontal.
4. Minimum axial length of Packing Version SpiralTrac is 1.000".
5. Packing Version SpiralTrac requires flush in positive flush flow, any other ports should be plugged.
6. EnviroSeal recommends high quality Chesterton® packing to sustain drip rate leakage.

Stuffing Box Measurements

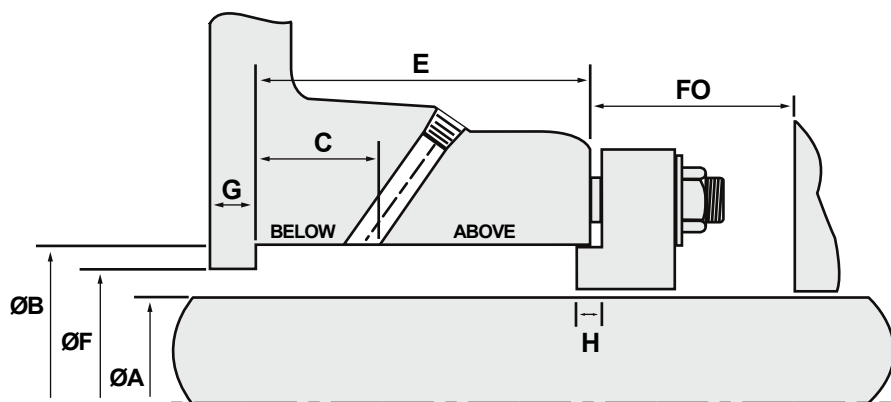

Units of measurement:

Inch Metric

ØA (Sleeve OD): _____

ØB (Box ID): _____

C (to edge of flush port): _____

E (Box depth): _____

ØF (Counter bore): _____

G (Counter bore width): _____

H (Gland nose length): _____

FO (First obstruction): _____

Split Solid

Shaft rotation as viewed from the motor end*:

*Double ended pumps require both R and L devices

R CW **L** CCW

not shown on diagram

D (current lantern ring axial width): _____

BELOW (current rings of packing below lantern ring): _____

ABOVE (current rings of packing above lantern ring): _____

Material

- ESC** (Carbon filled PTFE)
- 316** Stainless Steel
- 416** Stainless Steel
- 17-4PH** Stainless Steel
- BRZ** (660 Bronze)
- Other:** _____

Extra Information

Equipment

Flush rate: _____

Make/Model: _____

Size: _____

RPM: _____

Product: _____

Solids %: _____

Notes: _____

Distributor

Company: _____

Specialist: _____

P.O.#: _____

Customer: _____

Temperature: _____



2456 Rocky Lake Drive
Waverley, Nova Scotia, Canada
B2R 1R6

enviroseal.ca
info@enviroseal.ca
+1 (902) 861-3464

This document is available online at enviroseal.ca. Please email filled out form to support@enviroseal.ca

The information contained in this bulletin is accurate at time of print. The purchaser is responsible for ensuring the dimensions, quantity and applications suitability meet end user requirements. Most products are manufactured to order; therefore, EnviroSeal Engineering Products Ltd. retains the right to individually authorize returns based upon the potential for resale of the products within a reasonable period of time. Patent Protected WorldWide. SpiralTrac is a trademark of EnviroSeal Engineering Products Ltd.