SpiralTracTM

COMBINED QUOTE FORM

INSTRUCTIONS

This electronically fillable PDF document includes all four of our current SpiralTrac quote forms in one place. Please read our selection guide below and choose the right form to fill out based on your application.

You only have to fill out one page of this document!

1

SpiralTrac for Packing

Fill out this form if you plan on using mechanical packing with SpiralTrac.

2

SpiralTrac for Mechanical Seal

Fill out this form if you plan on using mechanical seal as your sealing solution.

3

SpiralTrac Adaptor

This form is for experienced specialists who have dealt with our adaptors in the past. Fill out this form if you know exactly what you need.

4

SpiralTrac for Vertical Turbine

Fill out this form if your equipment is a Vertical Turbine, regardless of your sealing solution. Make sure your equipment is a turbine and not a vertically oriented centrifugal pump.

Long years of experience has made the EnviroSeal Tech Support Team very good at understanding your SpiralTrac requirements based on a couple critical information. Fill out what you can and don't worry about leaving questions unanswered. We will make sure your quoted device is the right SpiralTrac for your application. If you have any questions email us at support@enviroseal.ca.

SpiralTrac™ Packing Version Quote Form

Configuration Note: For vertical turbines please refer to the *Vertical Turbine Quote Form* at enviroseal.ca

1. Sufficient flush pressure (1 Bar/15 psi above box pressure) to ensure a positive flow into the box is required.
2. EnviroSeal recommends that a flow meter and a check valve be utilized on the flush line.
3. Vertical applications sized the same as horizontal.
4. Minimum axial length of Packing Version SpiralTrac is 1.000".
5. Packing Version SpiralTrac requires flush in positive flush flow, any other ports should be plugged.
6. EnviroSeal recommends high quality Chesterton® packing to sustain drip rate leakage.

Stuffing Box Measurements

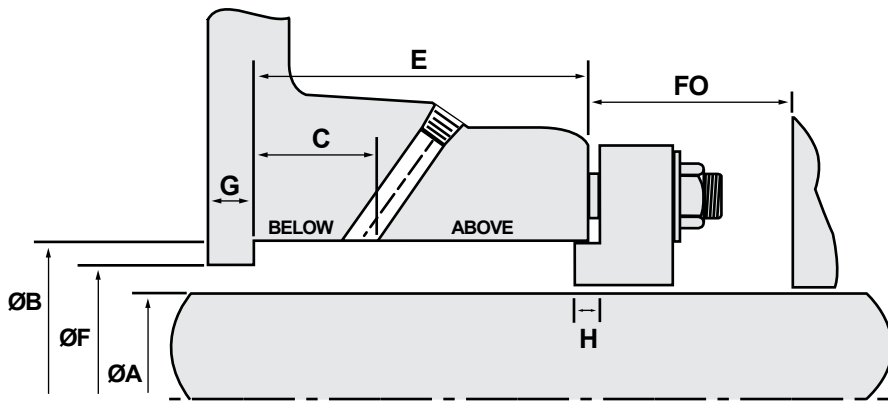

Units of measurement:

Inch Metric

ØA (Sleeve OD): _____

ØB (Box ID): _____

C (to edge of flush port): _____

E (Box depth): _____

ØF (Counter bore): _____

G (Counter bore width): _____

H (Gland nose length): _____

FO (First obstruction): _____

Split Solid

Shaft rotation as viewed from the motor end*:

*Double ended pumps require both R and L devices

R CW **L** CCW

not shown on diagram

D (current lantern ring axial width): _____

BELOW (current rings of packing below lantern ring): _____

ABOVE (current rings of packing above lantern ring): _____

Material

- ESC (Carbon filled PTFE)
- 316 Stainless Steel
- 416 Stainless Steel
- 17-4PH Stainless Steel
- BRZ (660 Bronze)
- Other: _____

Extra Information

Equipment

Flush rate: _____

Make/Model: _____

Size: _____

RPM: _____

Product: _____

Solids %: _____

Notes: _____

Distributor

Company: _____

Specialist: _____

P.O.#: _____

Customer: _____

Temperature: _____



2456 Rocky Lake Drive
Waverley, Nova Scotia, Canada
B2R 1R6

enviroseal.ca
info@enviroseal.ca
+1 (902) 861-3464

This document is available online at enviroseal.ca. Please email filled out form to support@enviroseal.ca

The information contained in this bulletin is accurate at time of print. The purchaser is responsible for ensuring the dimensions, quantity and applications suitability meet end user requirements. Most products are manufactured to order; therefore, EnviroSeal Engineering Products Ltd. retains the right to individually authorize returns based upon the potential for resale of the products within a reasonable period of time. Patent Protected WorldWide. SpiralTrac is a trademark of EnviroSeal Engineering Products Ltd.

SpiralTrac™ Seal Version

Quote Form

Required Information

Note: For vertical turbines please refer to the *Vertical Turbine Quote Form* at enviroseal.ca

Mechanical seal being used: _____ Flush available: No Yes* *Rate: _____

Units of measurement: Inch Metric

Shaft size*: _____
*or rotating element: sleeve, impeller hub, seal OD etc.

Bore size: _____ First obstruction: _____

Shaft rotation as viewed from the motor end*: **R** CW **L** CCW
*Double ended pumps require both R and L devices

Version

F (Flush required) **N** (Non fibrous applications) **D** (Fibrous applications) **C** (Chemical intermittent applications)

Installation Type

Type A

a width: _____

Øb diameter: _____

*option depends on throat diameter

Integral air vent option*

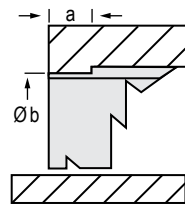

drilled air vent option*

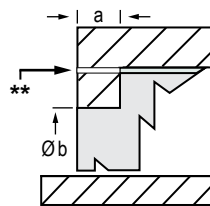

**recommended 0.156" (3.96mm) vent hole to release air when flooding.

Type B

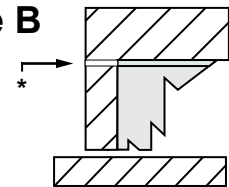

*recommended 0.156" (3.96mm) vent hole to release air when flooding.

Type E

a width: _____

Øb diameter: _____

c width: _____

Ød diameter: _____

Øe diameter: _____

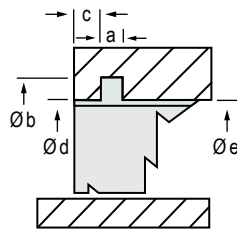

Type I

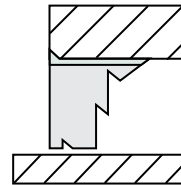

Type S

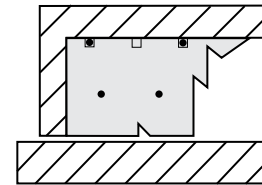

Material

- ESC** (Carbon filled PTFE)
- 316** Stainless Steel
- 416** Stainless Steel
- 17-4PH** Stainless Steel
- BRZ** (660 Bronze)
- Other:** _____

Extra Information

Equipment

Make/Model: _____

Size: _____

RPM: _____

Product: _____

Solids %: _____

Temperature: _____

Notes: _____

Distributor

Company: _____

Specialist: _____

P.O.#: _____

Customer: _____



2456 Rocky Lake Drive
Waverley, Nova Scotia, Canada
B2R 1R6

enviroseal.ca
info@enviroseal.ca
+1 (902) 861-3464

This document is available online at enviroseal.ca. Please email filled out form to support@enviroseal.ca

The information contained in this bulletin is accurate at time of print. The purchaser is responsible for ensuring the dimensions, quantity and applications suitability meet end user requirements. Most products are manufactured to order; therefore, EnviroSeal Engineering Products Ltd. retains the right to individually authorize returns based upon the potential for resale of the products within a reasonable period of time. Patent Protected WorldWide. SpiralTrac is a trademark of EnviroSeal Engineering Products Ltd.

SpiralTrac™ Adaptor

Quote Form

Configuration

- Sufficient flush pressure (1 Bar/15 psi above box pressure) to ensure a positive flow into the box is required.
- EnviroSeal recommends that a flow meter and a check valve be utilized on the flush line.
- Vertical applications sized the same as horizontal.

1: Seal Adaptor Packing Adaptor

2: Split Solid

3: **Shaft rotation as viewed from the motor end*:**

*Double ended pumps require both R and L devices

R CW

L CCW

Seal Adaptor

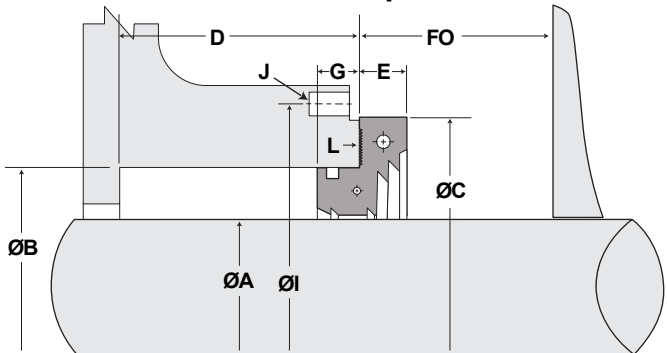

Packing Adaptor*

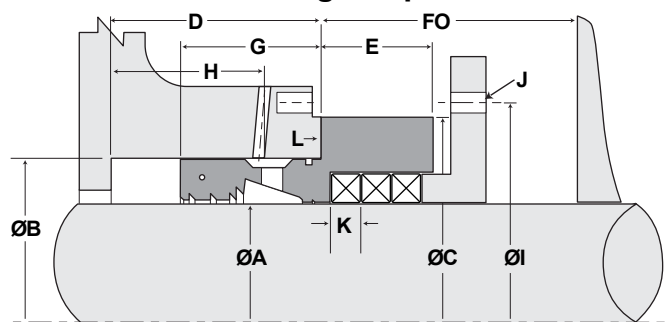

Measurements

Units of measurement: Inch Metric

Seal being used: _____

ØA (Sleeve OD): _____

ØB (Box ID): _____

ØC (Flange OD): _____

D (Box depth): _____

E (Flange width): _____

FO (First obstruction): _____



G (Nose width): _____

ØI (Bolt pattern/diameter): _____

J (Bolt Size): _____

H* (to edge of flush port): _____

K* (Packing size desired): _____

L (Gasket): *ESC only:*  *Metal only:* 
 Flat gasket not supplied by EnviroSeal

Material

- ESC (Carbon filled PTFE)
- 316 Stainless Steel
- 416 Stainless Steel
- 17-4PH Stainless Steel
- BRZ (660 Bronze)
- Other: _____

Extra Information

Flush rate: _____

Cavity Pressure: _____

Make/Model: _____

Size: _____

RPM: _____

Product: _____

Notes: _____

Distributor Company: _____

Specialist: _____

P.O.# _____

Customer: _____

Solids %: _____

Temperature: _____



2456 Rocky Lake Drive
 Waverley, Nova Scotia, Canada
 B2R 1R6

enviroseal.ca
 info@enviroseal.ca
 +1 (902) 861-3464

This document is available online at enviroseal.ca. Please email filled out form to support@enviroseal.ca

The information contained in this bulletin is accurate at time of print. The purchaser is responsible for ensuring the dimensions, quantity and applications suitability meet end user requirements. Most products are manufactured to order; therefore, EnviroSeal Engineering Products Ltd. retains the right to individually authorize returns based upon the potential for resale of the products within a reasonable period of time. Patent Protected WorldWide. SpiralTrac is a trademark of EnviroSeal Engineering Products Ltd.

Configuration

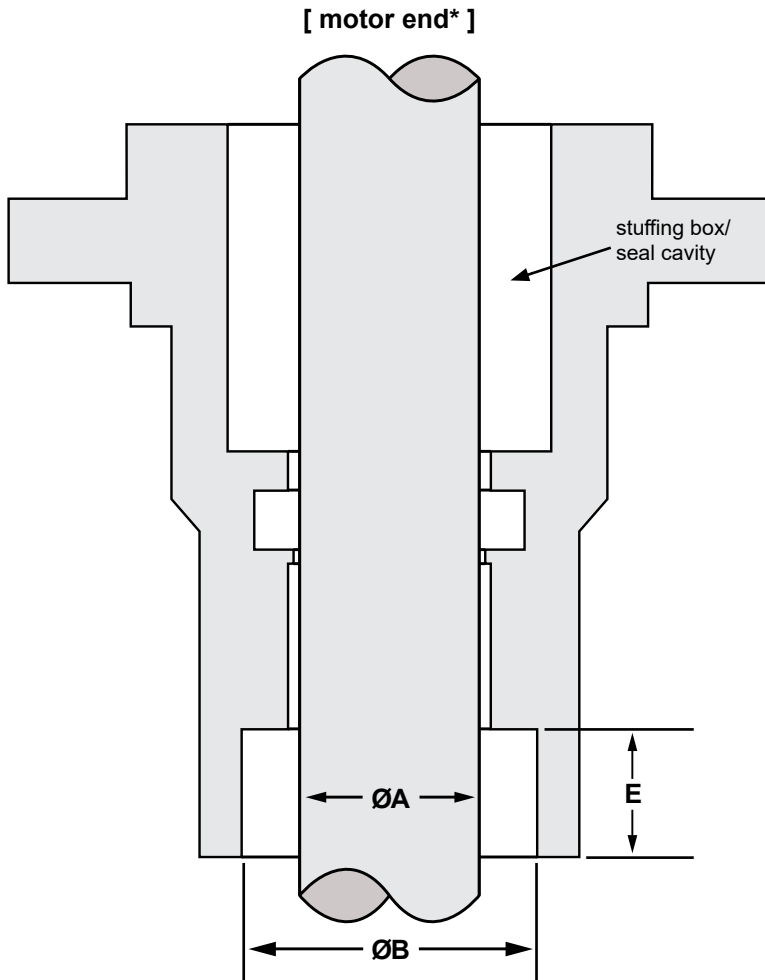

Can be used with Packing or Mechanical Seal!

*Shaft rotation as viewed from the motor end³:

R CW **L** CCW

Measurements

Units of measurement: Inch Metric

ØA (Shaft OD): _____

Typically dictated by EnviroSeal:

ØB (Cavity ID): _____

E (Cavity depth): _____

Note:

1. Minimum cross section required is **0.312"**
2. Minimum axial length for SpiralTrac is **1.000"**
3. Vertical turbine shaft is typically left hand rotation
4. Make sure equipment is a vertical turbine, not a vertically mounted centrifugal pump

Material

- 316 Stainless Steel
- 416 Stainless Steel
- 17-4PH Stainless Steel
- BRZ (660 Bronze)
- Other: _____

Extra Information

Equipment

Make: _____
 Model: _____
 Size: _____
 RPM: _____
 Product: _____
 Solids %: _____
 Notes: _____

Distributor

Company: _____
 Specialist: _____
 P.O.#: _____
 Customer: _____

Temperature: _____



2456 Rocky Lake Drive
 Waverley, Nova Scotia, Canada
 B2R 1R6

enviroseal.ca
 info@enviroseal.ca
 +1 (902) 861-3464

This document is available online at enviroseal.ca. Please email filled out form to support@enviroseal.ca

The information contained in this bulletin is accurate at time of print. The purchaser is responsible for ensuring the dimensions, quantity and applications suitability meet end user requirements. Most products are manufactured to order; therefore, EnviroSeal Engineering Products Ltd. retains the right to individually authorize returns based upon the potential for resale of the products within a reasonable period of time. Patent Protected WorldWide. SpiralTrac is a trademark of EnviroSeal Engineering Products Ltd.