

SpiralTrac™ Adaptor

Quote Form

Configuration

- Sufficient flush pressure (1 Bar/15 psi above box pressure) to ensure a positive flow into the box is required.
- EnviroSeal recommends that a flow meter and a check valve be utilized on the flush line.
- Vertical applications sized the same as horizontal.

1: Seal Adaptor Packing Adaptor

2: Split Solid

3: **Shaft rotation as viewed from the motor end*:**

*Double ended pumps require both R and L devices

R CW
 L CCW

Seal Adaptor

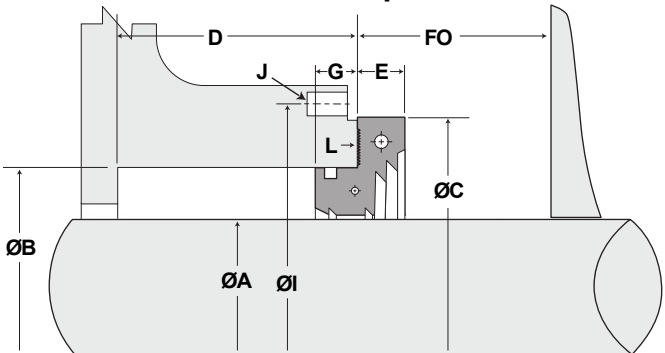

Packing Adaptor*

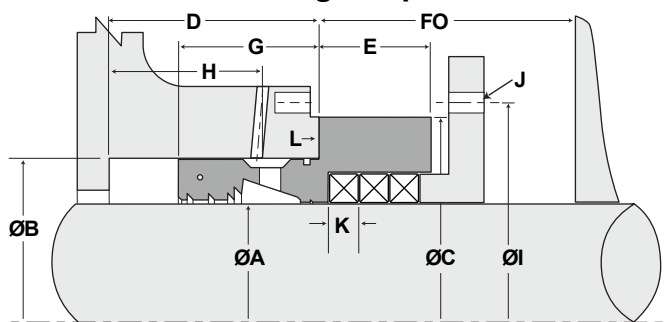

Measurements

Units of measurement: Inch Metric

Seal being used: _____

ØA (Sleeve OD): _____

ØB (Box ID): _____

ØC (Flange OD): _____

D (Box depth): _____

E (Flange width): _____

FO (First obstruction): _____



G (Nose width): _____

ØI (Bolt pattern/diameter): _____

J (Bolt Size): _____

H* (to edge of flush port): _____

K* (Packing size desired): _____

L (Gasket): *ESC only:*  *Metal only:* 
 Flat gasket not supplied by EnviroSeal

Material

- ESC (Carbon filled PTFE)
- 316 Stainless Steel
- 416 Stainless Steel
- 17-4PH Stainless Steel
- BRZ (660 Bronze)
- Other: _____

Extra Information

Flush rate: _____

Cavity Pressure: _____

Make/Model: _____

Size: _____

RPM: _____

Product: _____

Notes: _____

Distributor Company: _____

Specialist: _____

P.O.# _____

Customer: _____

Solids %: _____

Temperature: _____



2456 Rocky Lake Drive
 Waverley, Nova Scotia, Canada
 B2R 1R6

enviroseal.ca
 info@enviroseal.ca
 +1 (902) 861-3464

This document is available online at enviroseal.ca. Please email filled out form to support@enviroseal.ca

The information contained in this bulletin is accurate at time of print. The purchaser is responsible for ensuring the dimensions, quantity and applications suitability meet end user requirements. Most products are manufactured to order; therefore, EnviroSeal Engineering Products Ltd. retains the right to individually authorize returns based upon the potential for resale of the products within a reasonable period of time. Patent Protected WorldWide. SpiralTrac is a trademark of EnviroSeal Engineering Products Ltd.